

051/F9R2t5FBV

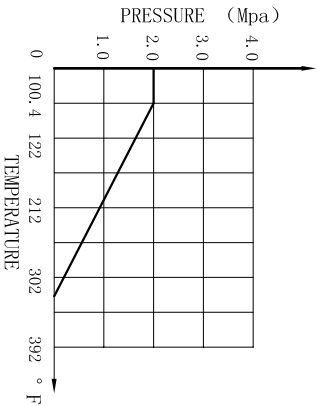
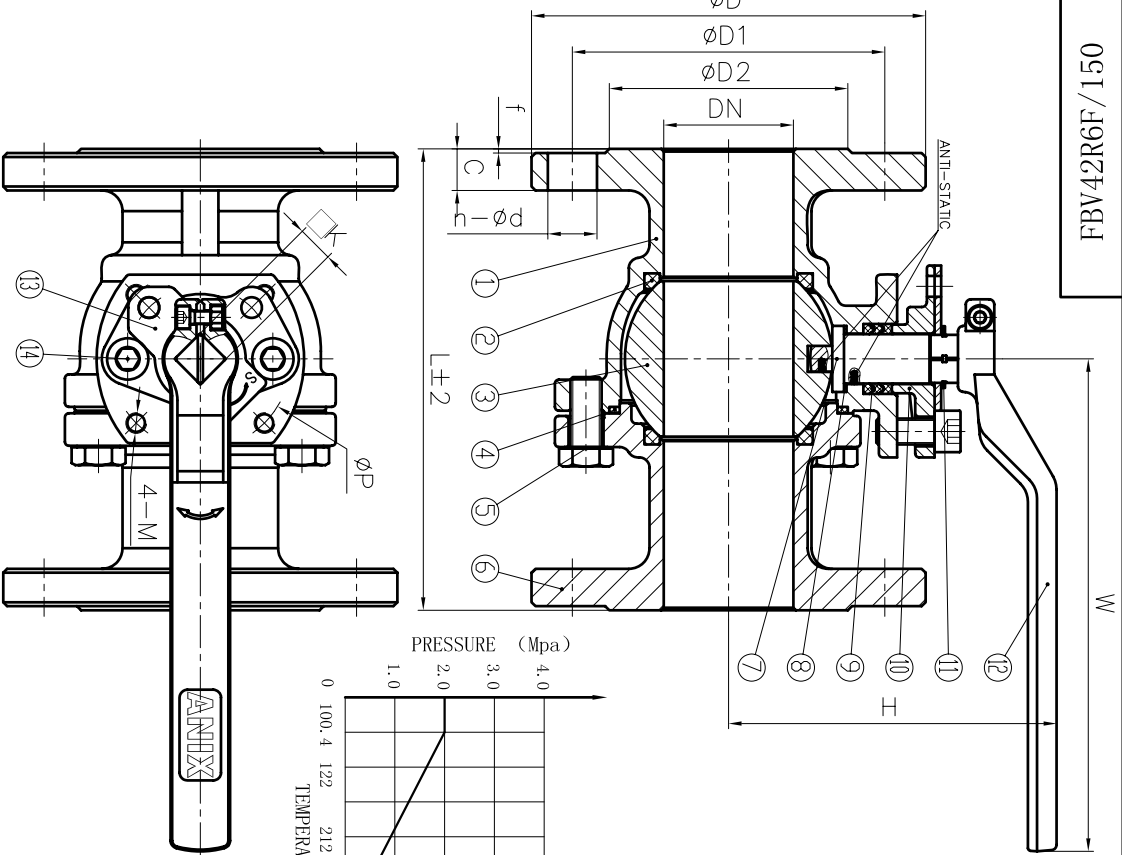

NPS	L	D	D1	D2	C	f	n- ϕ d	W	H	K	P	M	Weight (Lb)
1/2"	4.252	3.543	2.374	1.374	0.394	0.063	4- ϕ 0.63	5.118	3.189	0.354	1.654	MO.197	4.034
3/4"	4.606	3.937	2.752	1.689	0.433	0.063	4- ϕ 0.63	5.118	3.307	0.354	1.654	MO.197	5.071
1"	5.000	4.331	3.126	2.000	0.472	0.063	4- ϕ 0.63	6.299	3.583	0.433	1.969	MO.236	6.371
1 1/4"	5.512	4.528	3.500	2.500	0.512	0.063	4- ϕ 0.63	6.299	3.740	0.433	1.969	MO.236	9.127
1 1/2"	6.496	4.921	3.874	2.874	0.591	0.063	4- ϕ 0.63	7.874	4.646	0.551	2.756	MO.315	11.949
2"	7.008	5.906	4.752	3.626	0.630	0.063	4- ϕ 0.748	7.874	4.961	0.551	2.756	MO.315	16.248
2 1/2"	7.480	7.087	5.500	4.126	0.709	0.063	4- ϕ 0.748	9.449	5.394	0.551	2.756	MO.315	25.794
3"	7.992	7.480	6.000	5.000	0.748	0.063	4- ϕ 0.748	10.630	6.378	0.669	4.016	MO.394	31.967
4"	9.016	9.055	7.500	6.189	0.945	0.063	8- ϕ 0.748	12.598	7.402	0.669	4.016	MO.394	51.809

Nominal pressure	150LB			
Test pressure	Shell test	3.0		
	seal test	2.2		
	Gas seal test	0.6		
Applicable medium	water	water, oil, gas		
	air			
Applicable temperature	Test temperature	normal temperature		
	Temperature	-20~356°F		

NOTE:
 1. Design and Manufacture for valve according to ANSI B16.34-2009.
 2. Face-to-face dimensions for valve according to ASME B16.10-2009.
 3. End flange dimensions for valve according to ASME B16.5-2009.
 4. Inspection and Test for valve according to API 598-2009.

NO.	DESCRIPTION	QTY	MATERIAL
1	BODY	1	A351 CF8M
2	SEAT	2	RPPTFE
3	BALL	1	SS316
4	GASKET	1	RPPTFE
5	BOLT	-	A193 B8M
6	BONNET	1	A351 CF8M
7	STEM	1	A276 316
8	STEM WASHER	1	RPPTFE
9	PACKING	-	RPPTFE
10	GLAND	1	A351 CF8
11	SNAP RING	1	SS304
12	HANDLE	1	STAINLESS STEEL
13	STOPPER	1	SS304
14	HEXAGON HEAD BOLT	2	A193 B8M

MARK	BEFORE MODIFIED	AFTER MODIFIED	DATE	SCALE	FBV42R6F/150
DRAW.		APP.			
CHK.		DATE			

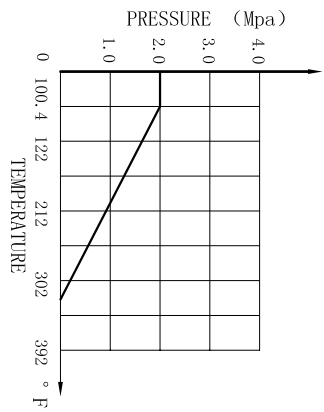
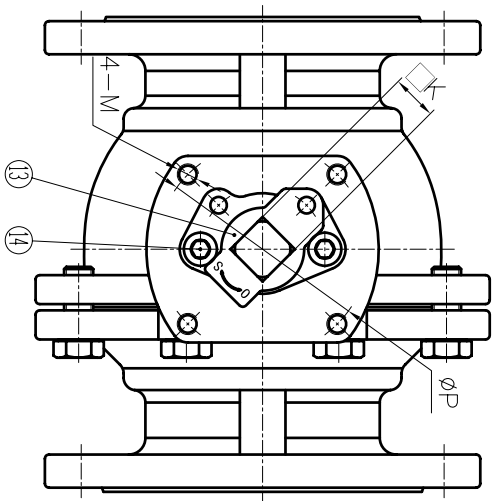
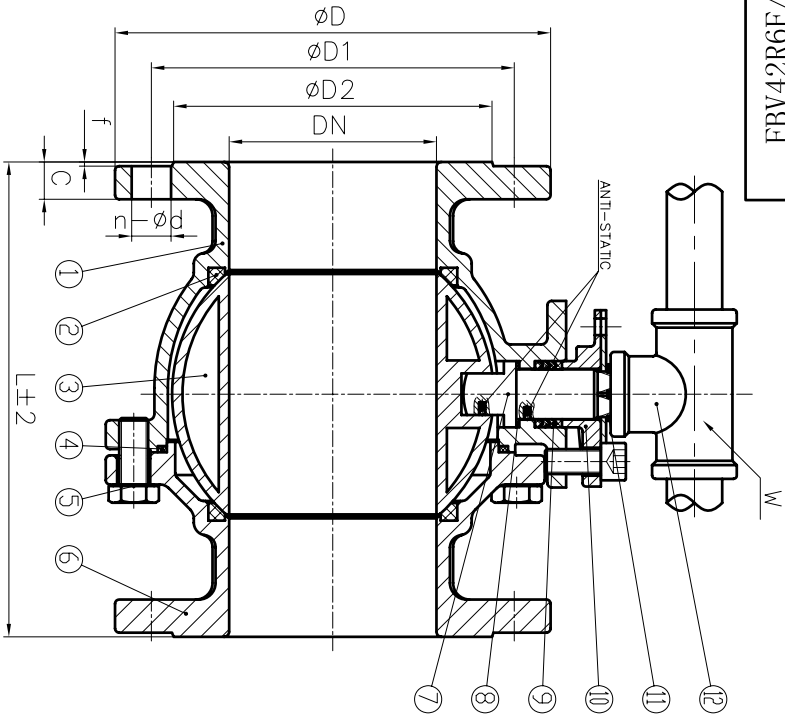

Nominal pressure		150LB	
Test pressure	Shell test	3.0	Mpa
	Gas seal test	2.2	
Test medium	water	air	Test temperature
	air		
Applicable temperature	water, oil, gas	-20~356°F	normal temperature

NPS	L	D	D1	D2	C	f	n-ød	W	K	P	M	Weight (lb)
5"	14.016	10.039	8.500	7.311	0.945	0.063	8-ø0.866	21.654	0.827	4.016	MO.394	69.997
6"	15.512	11.024	9.500	8.500	1.024	0.063	8-ø0.866	25.591	0.827	4.921	MO.472	109.129
8"	17.992	13.583	11.752	10.626	1.142	0.063	8-ø0.866	31.496	1.063	4.921	MO.472	176.370

14	HEXAGON HEAD BOLT	2	A193 B8M
13	STOPPER	1	SS304
12	HANDLE	1	STAINLESS STEEL
11	SNAP RING	1	SS304
10	GLAND	1	A351 CF8
9	PACKING	-	RPTFE
8	STEM WASHER	1	RPTFE
7	STEM	1	A276 316
6	BONNET	1	A351 CF8M
5	BOLT	-	A193 B8M
4	GASKET	1	RPTFE
3	BALL	1	SS316
2	SEAT	2	RPTFE
1	BODY	1	A351 CF8M
NO.	DESCRIPTION	QTY	MATERIAL

MARK	BEFORE MODIFIED	AFTER MODIFIED	DATE	SCALE
DRA.		APP.		
CHK.		DATE		

- NOTE:
1. Design and Manufacture for valve according to ANSI B16.34-2009.
 2. Face-to-face dimensions for valve according to ASME B16.10-2009.
 3. End flange dimensions for valve according to ASME B16.5-2009.
 4. Inspection and Test for valve according to API 598-2009.

Flange Ball Valve
150LB, CF8M, Fire Safe

FBV42R6F/150

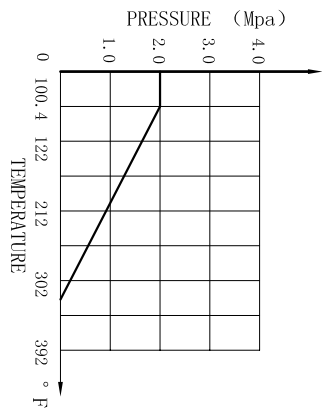
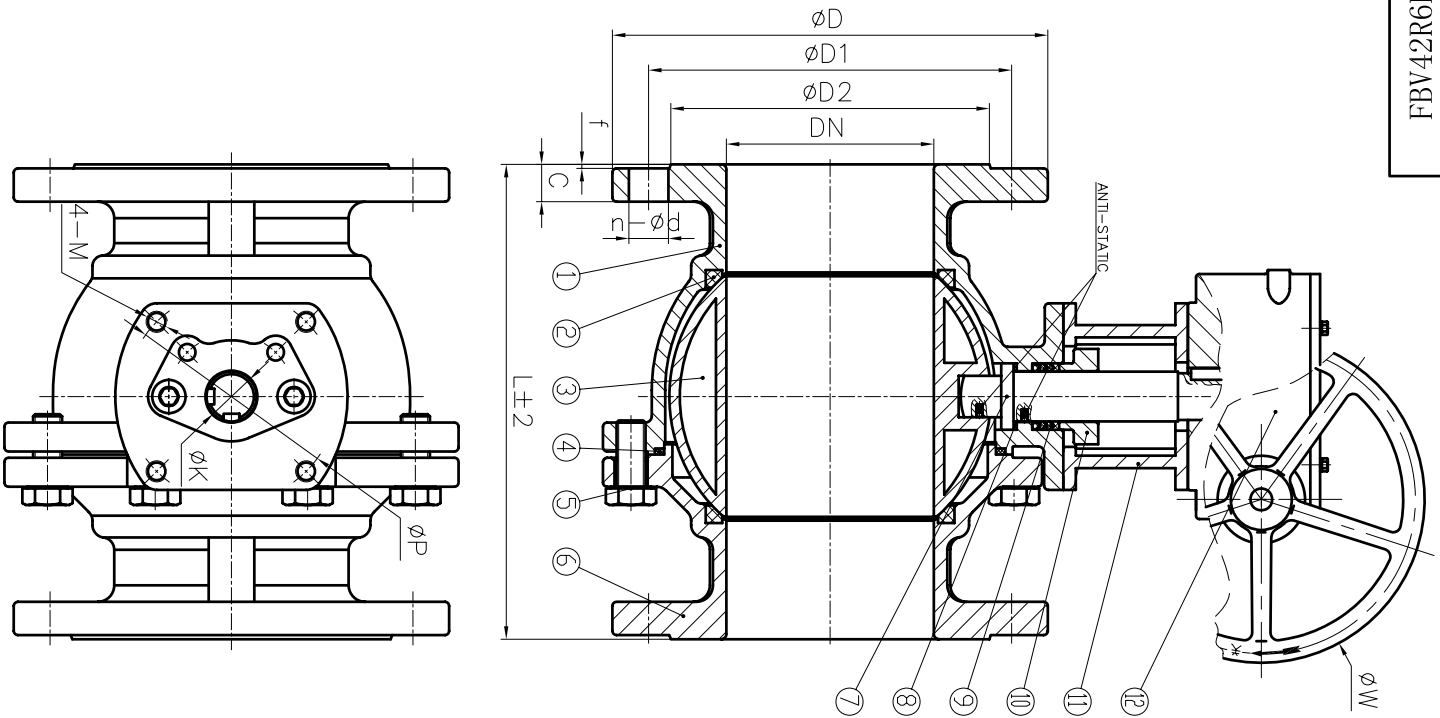

- NOTE:
1. Design and Manufacture for valve according to ANSI B16.34-2009.
 2. Face-to-Face dimensions for valve according to ASME B16.10-2009.
 3. End Flange dimensions for valve according to ASME B16.5-2009.
 4. Inspection and Test for valve according to API 598-2009.

Nominal pressure		150LB	
Test pressure	Shell test	3.0	test medium
	seal test	2.2	
Test pressure	Gas seal test	0.6	water
	test		air
Applicable medium		water, oil, gas	
Applicable temperature		-20~356 °F	

NPS	L	D	D1	D2	C	f	n- ϕ d	W	K	P	M	Weight (lb)	
10"	20.984	15.945	14.252	12.748	1.220	0.063	12- ϕ 0.984	15.748	1.772	5.512	M0.630	352.740	
WORM GEAR ACTUATOR													
12	/												
11	YOKE		1										A351 CF8
10	GLAND		1										A351 CF8
9	PACKING		-										RPTFE
8	STEM WASHER		1										RPTFE
7	STEM		1										A276 316
6	BONNET		1										A351 CF8M
5	BOLT		-										A193 B8M
4	GASKET		1										RPTFE
3	BALL		1										SS316
2	SEAT		2										RPTFE
1	BODY		1										A351 CF8M
NO.	DESCRIPTION		ϕ ' TY		MATERIAL								
MARK BEFORE MODIFIED													
MARK AFTER MODIFIED													
DRAW. APP. DATE SCALE													
CHK. DATE													
FBV42R6F/150													

Flange Ball Valve
150LB, CF8M, Fire Safe