

Building connections that last™



Series 3027

Gate Valve Datasheet

200 PSI CWP

½" – 2"



Gate Valve, 200 PSI CWP Series 3027



Design Feature

- 316 stainless steel (cast CF8M)
- Threaded in bonnet
- Threaded or socket weld ends
- Solid wedge disc
- Non-rising stem
- Hydrostatic shell test at 300 psi

Ratings

- 200 PSI CWP, non-shock
- 125 PSI Saturated Steam

Technical Information

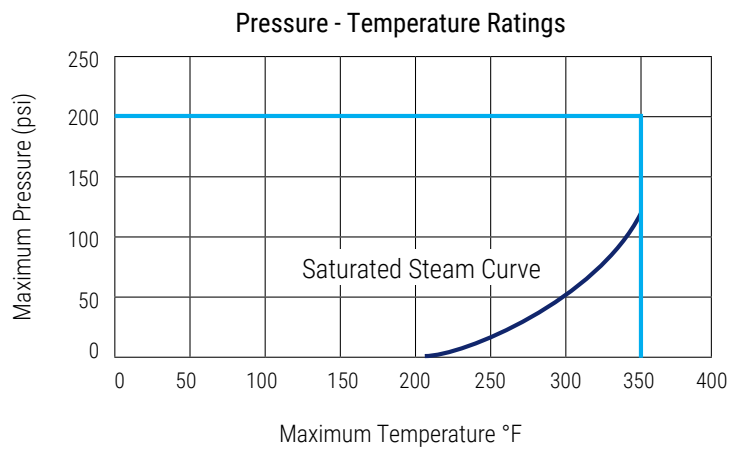

asc-es.com

Building connections that last™

Gate Valve, 200 PSI CWP

Series 3027



Parts & Materials

No.	Part Name	Qty.	Material
1	Body	1	316 Stainless Steel
2	Disc	1	316 Stainless Steel
3	Stem	1	316 Stainless Steel
4	Cap	1	316 Stainless Steel
5	Seal	1	PTFE
6	Washer	1	316 Stainless Steel
7	Thick Washer	1	316 Stainless Steel
8	Packing	1	PTFE
9	Bush	1	304 Stainless Steel
10	Gland Nut	1	304 Stainless Steel
11	Handle Wheel	1	Aluminum
12	Name Plate	1	Aluminum
13	Nut	1	304 Stainless Steel

Dimensions (Inches)

Size	A	B	C	D
½	0.59	2.16	3.82	2.76
¾	0.79	2.36	4.06	2.76
1	0.98	2.68	4.53	3.15
1-¼	1.26	2.99	5.12	3.15
1-½	1.56	3.15	6.06	3.94
2	1.97	3.66	6.77	3.94

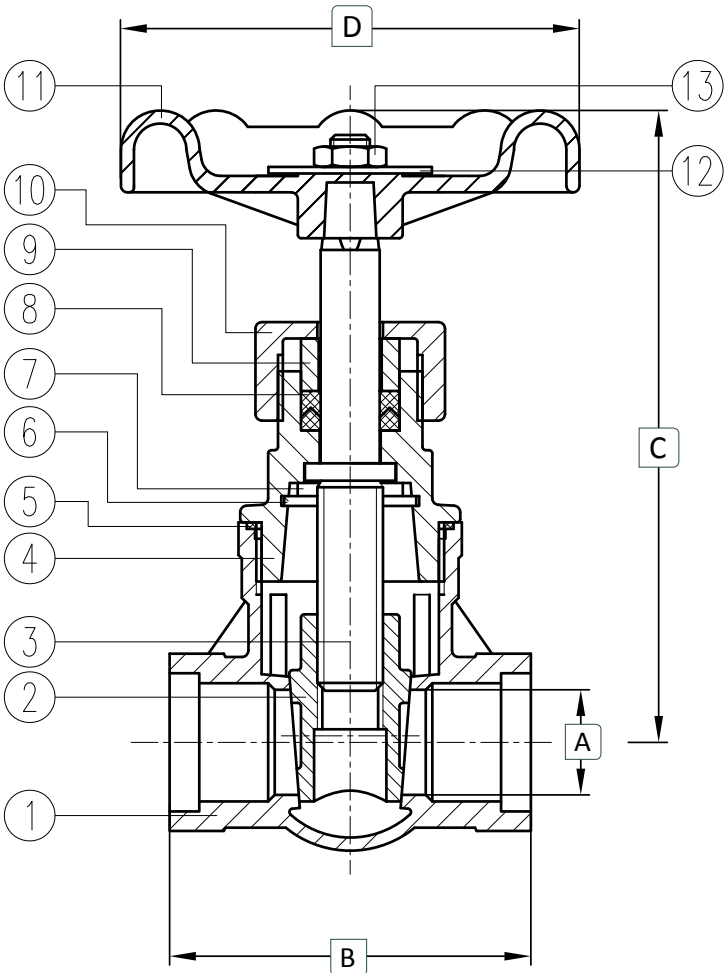



How to Order
Series 3027

1	-	3027	6	-	TE
Size		Series			Ends
1/4		3027			TE Threaded
3/8					SW Socket Weld
1/2					
3/4					
1					
1-1/4					
1-1/2					
2					

Note:
Responsibility for proper selection, use and maintenance of any product remains solely with the purchaser and end user. We reserve the right to modify or improve the designs or specifications of any product at any time without notice.

About ASC Engineered Solutions

ASC Engineered Solutions is defined by quality—in its products, services and support. With nearly 2,000 employees, the company's portfolio of precision-engineered piping support, valves and connections provides products to more than 4,000 customers across industries, such as mechanical, industrial, fire protection, oil and gas, and commercial and residential construction. Its portfolio of leading brands includes ABZ Valve®, AFCON®, Anvil®, Anvil EPS, Anvil Services, Basic-PSA, Beck®, Catawissa, Cooplet®, FlexHead®, FPPI®, Gruvlok®, J.B. Smith, Merit®, North Alabama Pipe, Quadrant®, SCI®, Sharpe®, SlideLOK®, SPF®, SprinkFLEX®, Trenton Pipe and VEP. With headquarters in Oak Brook, IL, ASC also has ISO 9001:2015 certified production facilities in PA, TN, IL, TX, AL, LA, KS, and RI.



asc-es.com

Building connections that last™

FC-DS-SERIES-3027-v02 20240423

