

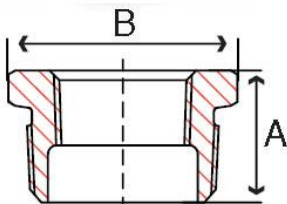

- Class 150 pipe fittings are UL Listed and FM Approved at 300 psi
- Class 300 pipe fittings are UL Listed
- Hot-dipped galvanized pipe fittings are certified to; NSF/ANSI 61-4 & California AB1953 Lead Free
- Malleable castings conform to ASTM A197, ASME B16.3, ASME B16.14 & ASME B16.39
- Hot-dipped galvanized pipe fittings conform to ASTM A153
- NPT threads on all pipe fittings conform to ASME B1.20.1
- Independent lab verification: fittings meet applicable chemical & physical properties.
- Manufacturing facilities are ISO 9001:2008 & ISO 14001.
- Fittings are 100% air tested.
- Canadian Registration Numbers (CRN) available

Hex Bushings - Black & Galvanized



Size	Black PT#	Galvanized PT#	A (in.)	B	HEX	Wt. (lb.)
1/4 x 1/8	B15033HB1002001C	G15034HB1002001C	0.61	0.066	Out	0.05
3/8 x 1/8	B15033HB1003001C	G15034HB1003001C	0.81	0.73	Out	0.05
3/8 x 1/4	B15033HB1003002C	G15034HB1003002C	0.81	0.73	Out	0.05
1/2 x 1/8	B15033HB1004001C	G15034HB1004001C	0.95	0.88	Out	0.1
1/2 x 1/4	B15033HB1004002C	G15034HB1004002C	0.95	0.88	Out	0.1
1/2 x 3/8	B15033HB1004003C	G15034HB1004003C	0.95	0.88	Out	0.1
3/4 x 1/8	B15033HB1006001C	G15034HB1006001C	0.95	1.18	Out	0.2
3/4 x 1/4	B15033HB1006002C	G15034HB1006002C	1.05	1.18	Out	0.2
3/4 x 3/8	B15033HB1006003C	G15034HB1006003C	1.05	1.18	Out	0.2
3/4 x 1/2	B15033HB1006004C	G15034HB1006004C	1.05	1.18	Out	0.2
1 x 1/8	B15033HB1010001C	G15034HB1010001C	1.12	1.15	In	0.2
1 x 1/4	B15033HB1010002C	G15034HB1010002C	1.12	1.15	In	0.2
1 x 3/8	B15033HB1010003C	G15034HB1010003C	1.16	1.40	Out	0.2
1 x 1/2	B15033HB1010004C	G15034HB1010004C	1.16	1.40	Out	0.2
1 x 3/4	B15033HB1010006C	G15034HB1010006C	1.18	1.40	Out	0.2
1-1/4 x 1/4	B15033HB1012002C	G15034HB1012002C	1.16	1.15	In	0.4
1-1/4 x 3/8	B15033HB1012003C	G15034HB1012003C	1.20	1.15	In	0.4
1-1/4 x 1/2	B15033HB1012004C	G15034HB1012004C	1.25	1.38	In	0.4
1-1/4 x 3/4	B15033HB1012006C	G15034HB1012006C	1.25	1.80	Out	0.3
1-1/4 x 1	B15033HB1012010C	G15034HB1012010C	1.25	1.80	Out	0.3
1-1/2 x 1/8	B15033HB1014001C	G15034HB1014001C	1.30	1.18	In	0.4
1-1/2 x 1/4	B15033HB1014002C	G15034HB1014002C	1.30	1.18	In	0.6
1-1/2 x 3/8	B15033HB1014003C	G15034HB1014003C	1.30	1.18	In	0.6
1-1/2 x 1/2	B15033HB1014004C	G15034HB1014004C	1.30	1.40	In	0.5
1-1/2 x 3/4	B15033HB1014006C	G15034HB1014006C	1.30	1.66	In	0.5
1-1/2 x 1	B15033HB1014010C	G15034HB1014010C	1.30	1.95	Out	0.5
1-1/2 x 1-1/4	B15033HB1014012C	G15034HB1014012C	1.30	1.95	Out	0.3
2 x 1/4	B15033HB1020002C	G15034HB1020002C	1.40	1.18	In	0.7
2 x 3/8	B15033HB1020003C	G15034HB1020003C	1.40	1.18	In	0.8
2 x 1/2	B15033HB1020004C	G15034HB1020004C	1.50	1.37	In	0.9
2 x 3/4	B15033HB1020006C	G15034HB1020006C	1.50	1.68	In	0.9
2 x 1	B15033HB1020010C	G15034HB1020010C	1.50	1.97	In	0.8
2 x 1-1/4	B15033HB1020012C	G15034HB1020012C	1.50	2.55	Out	0.7
2 x 1-1/2	B15033HB1020014C	G15034HB1020014C	1.50	2.55	Out	0.7
2-1/2 x 1/2	B15033HB1024004C	G15034HB1024004C	1.70	3.25	Out	1.5
2-1/2 x 3/4	B15033HB1024006C	G15034HB1024006C	1.58	1.65	In	1.5
2-1/2 x 1	B15033HB1024010C	G15034HB1024010C	1.58	2.00	In	1.5
2-1/2 x 1-1/4	B15033HB1024012C	G15034HB1024012C	1.58	2.40	In	1.4
2-1/2 x 1-1/2	B15033HB1024014C	G15034HB1024014C	1.58	2.70	In	1.4

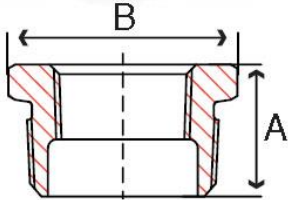

Size	Black PT#	Galvanized PT#	A (in.)	B	HEX	Wt. (lb.)
2-1/2 x 2	B15033HB1024020C	G15034HB1024020C	1.65	3.00	Out	1.1
3 x 1/2	B15033HB1030004C	G15034HB1030004C	1.88	3.80	Out	2.0
3 x 3/4	B15033HB1030006C	G15034HB1030006C	1.75	1.70	In	1.9
3 x 1	B15033HB1030010C	G15034HB1030010C	1.70	2.00	In	2.1
3 x 1-1/4	B15033HB1030012C	G15034HB1030012C	1.70	2.40	In	2.1
3 x 1-1/2	B15033HB1030014C	G15034HB1030014C	1.70	2.70	In	2.2
3 x 2	B15033HB1030020C	G15034HB1030020C	1.80	3.70	Out	2.0
3 x 2-1/2	B15033HB1030024C	G15034HB1030024C	1.90	3.90	Out	1.6
3-1/2 x 1-1/2	B15033HB1034014C	G15034HB1034014C	1.75	2.75	In	1.5
3-1/2 x 2	B15033HB1034020C	G15034HB1034020C	1.94	1.80	In	2.4
3-1/2 x 2-1/2	B15033HB1034024C	G15034HB1034024C	1.70	4.30	Out	2.5
3-1/2 x 3	B15033HB1034030C	G15034HB1034030C	1.75	4.60	Out	1.9
4 x 3/4	B15033HB1040006C	G15034HB1040006C	2.00	2.00	In	4.4
4 x 1	B15033HB1040010C	G15034HB1040010C	1.90	2.00	In	4.5
4 x 1-1/4	B15033HB1040012C	G15034HB1040012C	1.90	2.40	In	2.7
4 x 1-1/2	B15033HB1040014C	G15034HB1040014C	1.90	2.70	In	4.2
4 x 2	B15033HB1040020C	G15034HB1040020C	1.90	3.30	In	3.8
4 x 2-1/2	B15033HB1040024C	G15034HB1040024C	2.10	4.70	In	3.9
4 x 3	B15033HB1040030C	G15034HB1040030C	2.10	4.70	Out	3.3
4 x 3-1/2	B15033HB1040034C	G15034HB1040034C	2.33	4.75	Out	2.5
5 x 2	B15033HB1050020C	G15034HB1050020C	2.05	3.30	In	5.1
5 x 2-1/2	B15033HB1050024C	G15034HB1050024C	2.10	4.00	In	4.8
5 x 3	B15033HB1050030C	G15034HB1050030C	2.10	4.70	In	4.4
5 x 4	B15033HB1050040C	G15034HB1050040C	2.10	5.80	Out	4.0