

**Technical Specifications:**

- Forged stainless steel material conforms to ASME A182
- Forged stainless steel flange dimensions conform to ASME B16.5
- NPT threads conform to ASME B1.20.1
- Manufacturing facility is ISO 9001:2008

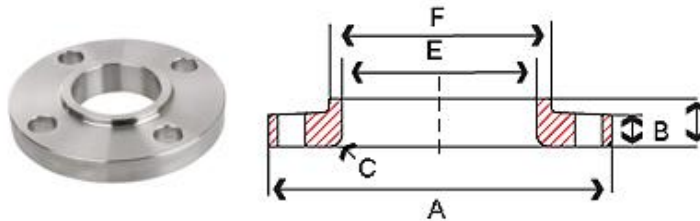

**150# Lap Joint Flanges – Stainless Steel 304/304L & 316/316L**

Size IN	A IN	B IN	C IN	D IN	E IN	F IN	Bolt Circle IN	Bolt Hole Diameter IN	# of Bolt Holes	Weight lbs
1/2	3.50	0.44	0.12	0.62	0.90	1.19	2.38	0.62	4	1
3/4	3.88	0.50	0.12	0.62	1.11	1.50	2.75	0.62	4	2
1	4.25	0.56	0.12	0.69	1.38	1.94	3.12	0.62	4	2
1-1/4	4.62	0.62	0.19	0.81	1.72	2.31	3.50	0.62	4	3
1-1/2	5.00	0.69	0.25	0.88	1.97	2.56	3.88	0.62	4	3
2	6.00	0.75	0.31	1.00	2.46	3.06	4.75	0.75	4	5
2-1/2	7.00	0.88	0.31	1.12	2.97	3.56	5.50	0.75	4	7
3	7.50	0.94	0.38	1.19	3.60	4.25	6.00	0.75	4	8
3-1/2	8.50	0.94	0.38	1.25	4.10	4.81	7.00	0.75	8	11
4	9.00	0.94	0.44	1.31	4.60	5.31	7.50	0.75	8	13
5	10.00	0.94	0.44	1.44	5.69	6.44	8.50	0.88	8	15
6	11.00	1.00	0.50	1.56	6.75	7.56	9.50	0.88	8	19
8	13.50	1.12	0.50	1.75	8.75	9.69	11.75	0.88	8	30
10	16.00	1.19	0.50	1.94	10.92	12.00	14.25	1.00	12	43
12	19.00	1.25	0.50	2.19	12.92	14.38	17.00	1.00	12	64

**300# Lap Joint Flanges – Stainless Steel 304/304L & 316/316L**

Size IN	A IN	B IN	C IN	D IN	E IN	F IN	Bolt Circle IN	Bolt Hole Diameter IN	# of Bolt Holes	Weight lbs
1/2	3.75	0.56	0.12	0.88	0.90	1.50	2.62	0.62	4	2
3/4	4.62	0.62	0.12	1.00	1.11	1.88	3.25	0.75	4	3
1	4.88	0.69	0.12	1.06	1.38	2.12	3.50	0.75	4	3
1-1/4	5.25	0.75	0.19	1.06	1.72	2.50	3.88	0.75	4	4
1-1/2	6.12	0.81	0.25	1.19	1.97	2.75	4.50	0.88	4	6
2	6.50	0.88	0.31	1.31	2.46	3.31	5.00	0.75	4	7
3	8.25	1.12	0.38	1.69	3.60	4.62	6.62	0.88	4	13
4	10.00	1.25	0.44	1.88	4.60	5.75	7.88	0.88	8	22