

AN ADAPTER AA

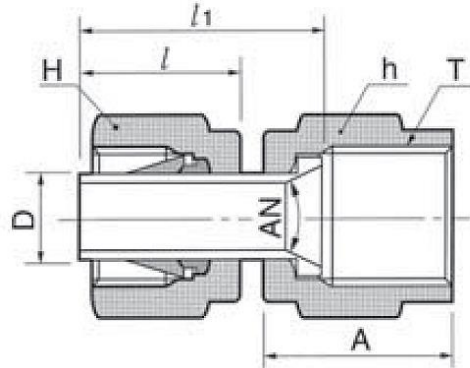

Connects fractional BFO-Lok port tube to AN male
Classification: Tube x AN Tube
Ferrule System: Double Ferrule

Part No.	Tube O.D.		AN Tube Flare Size		Straight Thread T(U)	Width Across Flat				A	l	l1
	in.	mm	in.	mm		h		H				
						in.	mm	in.	mm			
30-AA-1/8-1/8	1/8	3.17	1/8	3.17	5/16-24	3/8	9.52	7/16	11.11	13.71	13.46	18.54
30-AA-1/8-1/4	1/8	3.17	1/4	6.35	7/16-20	9/16	14.28	7/16	11.11	15.74	13.46	19.05
30-AA-1/4-1/4	1/4	6.35	1/4	6.35	7/16-20	9/16	14.28	9/16	14.28	15.74	15.74	21.33
30-AA-3/8-3/8	3/8	9.52	3/8	9.52	9/16-18	11/16	17.46	11/16	17.46	18.28	17.52	24.89
30-AA-1/2-1/2	1/2	12.70	1/2	12.70	3/4-16	7/8	22.22	7/8	22.22	21.59	23.11	31.75

All dimensions are in millimeters unless otherwise specified and only for reference and subject to change.
 Request a quote for any sizes not listed online.

AN adapter is useful to connects BFO-Lok port to SAE JIC 514 37 male Fitting.

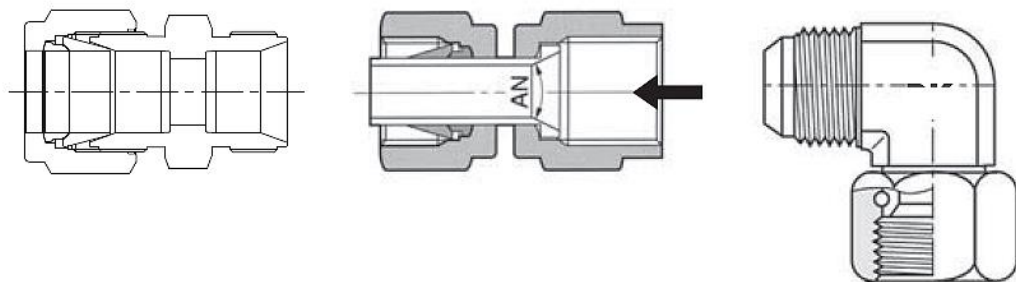

ADDITIONAL PRODUCT INFORMATION

COMPETITOR PART NUMBER			
BFO SKU#	SWAGELOK	SSP DUOLOK	PARKER A-LOK
30-AA-1/8-1/8	SS-200-A-2ANF	ISSD2ANF2	2X6TU2-SS
30-AA-1/8-1/4	SS-200-A-4ANF	ISSD2ANF4	2X6TU4-SS
30-AA-1/4-1/4	SS-400-A-4ANF	ISSD4ANF4	4X6TU4-SS
30-AA-3/8-3/8	SS-600-A-6ANF	ISSD6ANF6	6X6TU6-SS
30-AA-1/2-1/2	SS-810-A-8ANF	ISSD8ANF8	8X6TU8-SS

ADDITIONAL TUBE COMPRESSION FITTING DATA



AN ADAPTERS

Tube to AN connectors are designed to connect onto individual tube lines leaving a 37 degree male JIC connection typically for connecting to a flexible hose having a female 37 degree swivel nut; in both single ferrule and double ferrule designs.

- Uses include: instrumentation, high pressure and temperature, cryogenic service, and process and control systems where high-quality tube fittings are required.
- These tube fittings are designed using industrial codes and specifications with additional cutting-edge engineering on swaging action and sealing integrity.
- They also provide excellent leak-free sealing on high pressure gas, vacuum, impulse, thermal shock, heavy vibration and many other stringent applications.
- All tube fittings are double ferrule and consist of a body, front ferrule, back ferrule and nut.
- Stainless steel barstock conforms to ASTM A276, ASTM 479, ASME SA479 and JIS GA 303
- Stainless steel forged fittings conform to ASTM A182, ASME SA 182 and JIS G3214
- The pressure rating of a BFO Tube Fitting is rated to the [working pressure of the connective tubing](#).
- CAD drawings available upon request.