

## AN BULKHEAD UNION ABU

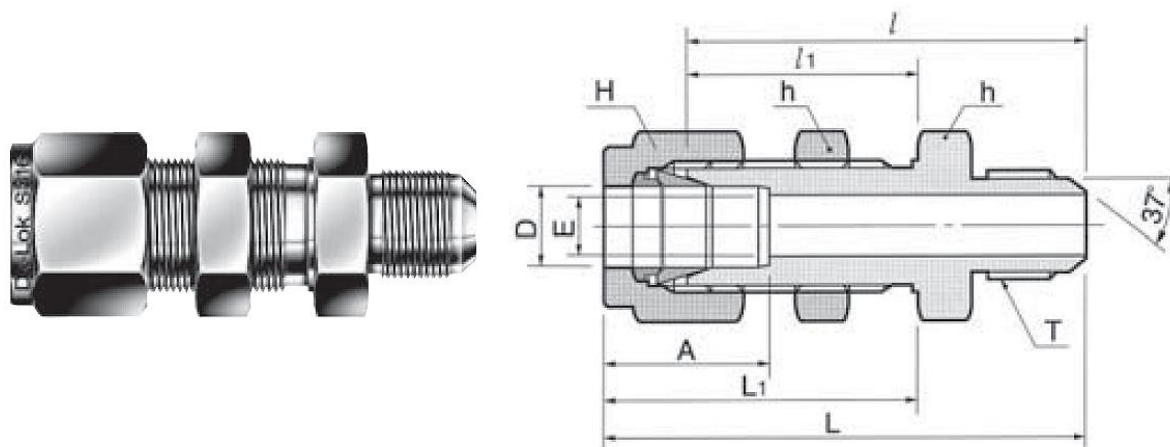

Connects fractional tube x AN flared tube

Classification: Tube x AN Tube

Ferrule System: Double Ferrule

| Part No.       | Tube O.D. |       | AN Tube Flare Size |       | Straight Thread T(U) | E Min | Width Across Flat |       |       |       | A     | I     | I 1   | L     | L1    | Panel Hole Drill Size | Panel Max Thickness |
|----------------|-----------|-------|--------------------|-------|----------------------|-------|-------------------|-------|-------|-------|-------|-------|-------|-------|-------|-----------------------|---------------------|
|                |           |       |                    |       |                      |       | h                 |       | H     |       |       |       |       |       |       |                       |                     |
|                | in.       | mm    | in.                | mm    |                      |       | in.               | mm    | in.   | mm    |       |       |       |       |       |                       |                     |
| 30-ABU-1/8-1/8 | 1/8       | 3.17  | 1/8                | 3.17  | 5/16-24              | 1.77  | 1/2               | 12.70 | 7/16  | 11.11 | 13.71 | 40.85 | 24.63 | 47.45 | 31.23 | 8.33                  | 12.70               |
| 30-ABU-1/4-1/4 | 1/4       | 6.35  | 1/4                | 6.35  | 7/16-20              | 4.31  | 5/8               | 15.87 | 9/16  | 14.28 | 15.24 | 46.48 | 26.16 | 53.84 | 33.52 | 11.50                 | 10.16               |
| 30-ABU-3/8-3/8 | 3/8       | 9.52  | 3/8                | 9.52  | 9/16-18              | 7.11  | 3/4               | 19.05 | 11/16 | 17.46 | 16.76 | 49.78 | 29.46 | 57.15 | 36.83 | 14.68                 | 11.17               |
| 30-ABU-1/2-1/2 | 1/2       | 12.70 | 1/2                | 12.70 | 3/4-16               | 9.90  | 5/16              | 23.81 | 7/8   | 22.22 | 22.86 | 55.62 | 31.75 | 65.78 | 41.91 | 19.44                 | 12.70               |
| 30-ABU-3/4-3/4 | 3/4       | 19.05 | 3/4                | 19.05 | 1-1/16-12            | 15.49 | 1-3/16            | 30.16 | 1-1/8 | 28.58 | 24.38 | 68.83 | 37.33 | 78.99 | 47.49 | 25.79                 | 16.76               |

| Part No.           | Tube O.D. |       | AN Tube Flare Size |       | Straight Thread T(U) | E Min | Width Across Flat |       |       |       | A     | I      | I 1   | L      | L1    | Panel Hole Drill Size | Panel Max Thickness |
|--------------------|-----------|-------|--------------------|-------|----------------------|-------|-------------------|-------|-------|-------|-------|--------|-------|--------|-------|-----------------------|---------------------|
|                    |           |       |                    |       |                      |       | h                 |       | H     |       |       |        |       |        |       |                       |                     |
|                    | in.       | mm    | in.                | mm    |                      |       | in.               | mm    | in.   | mm    |       |        |       |        |       |                       |                     |
| 30-ABU-1-1         | 1         | 25.40 | 1                  | 25.40 | 1-5/16-12            | 21.33 | 1-5/8             | 41.27 | 1-1/2 | 38.10 | 31.24 | 80.26  | 45.21 | 92.45  | 57.40 | 33.73                 | 19.05               |
| 30-ABU-1-1/4-1-1/4 | 1-1/4     | 31.75 | 1-1/4              | 31.75 | 1-5/8-12             | 27.68 | 1-7/8             | 47.63 | 1-7/8 | 47.63 | 41.14 | 86.37  | 47.75 | 108.47 | 69.85 | 41.67                 | 19.05               |
| 30-ABU-1-1/2-1-1/2 | 1-1/2     | 38.10 | 1-1/2              | 38.10 | 1-7/8-12             | 33.90 | 2-1/4             | 57.15 | 2-1/4 | 57.15 | 50.03 | 94.33  | 49.27 | 121.51 | 76.45 | 49.61                 | 19.05               |
| 30-ABU-2-2         | 2         | 50.80 | 2                  | 50.80 | 2-1/2-12             | 45.97 | 2-3/4             | 69.85 | 3     | 76.20 | 67.56 | 114.29 | 56.38 | 151.62 | 93.71 | 16.27                 | 19.05               |

All dimensions are in millimeters unless otherwise specified and only for reference and subject to change.  
Request a quote for any sizes not listed online.

## ADDITIONAL TUBE COMPRESSION FITTING DATA

Tube to AN connectors are designed to connect onto individual tube lines leaving a 37 degree male JIC connection typically for connecting to a flexible hose having a female 37 degree swivel nut; in both single ferrule and double ferrule designs.



### AN BULKHEAD UNION

- Uses include: instrumentation, high pressure and temperature, cryogenic service, and process and control systems where high-quality tube fittings are required.
- These tube fittings are designed using industrial codes and specifications with additional cutting-edge engineering on swaging action and sealing integrity.
- They also provide excellent leak-free sealing on high pressure gas, vacuum, impulse, thermal shock, heavy vibration and many other stringent applications.
- All tube fittings are double ferrule and consist of a body, front ferrule, back ferrule and nut.
- Stainless steel barstock conforms to ASTM A276, ASTM 479, ASME SA479 and JIS GA 303
- Stainless steel forged fittings conform to ASTM A182, ASME SA 182 and JIS G3214
- The pressure rating of a BFO Tube Fitting is rated to the [working pressure of the connective tubing](#).
- CAD drawings available upon request.