

# MALE ADAPTER MA

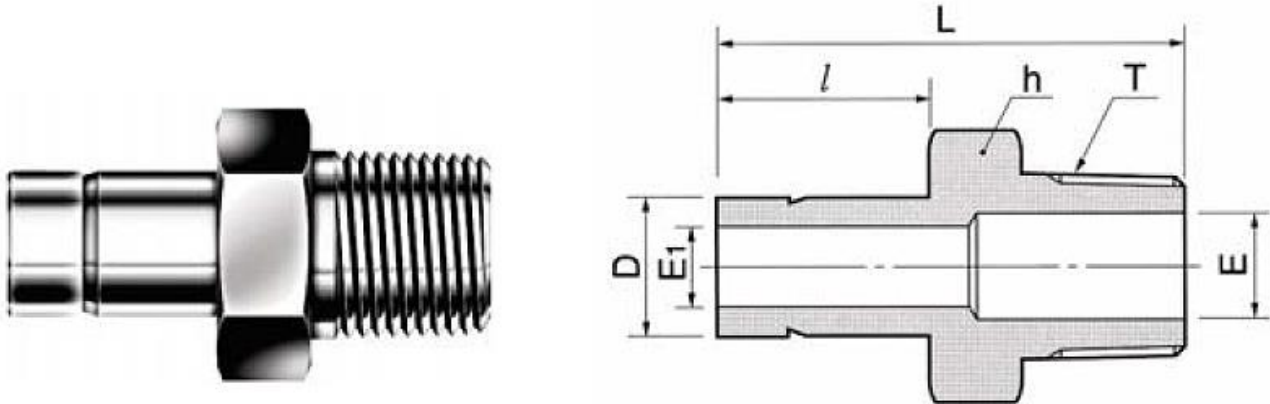

Connects fractional compression tube end to female NPT thread  
 Classification: Tube Stub Connectors

Part No.	Tube O.D. D		T NPT	E Min.	E1	Width Across Flat (h)		l	L
	in.	mm				in.	mm		
30-MA-1/8-1/8	1/8	3.17	1/8	2.28	1.77	7/16	11.11	13.45	29.50
30-MA-1/8-1/4	1/8	3.17	1/4	6.35	1.77	9/16	14.28	13.45	34.80
30-MA-3/16-1/8	3/16	4.76	1/8	3.04	3.04	7/16	11.11	14.20	30.22
30-MA-3/16-1/4	3/16	4.76	1/4	6.35	3.04	9/16	14.28	14.20	35.56
30-MA-1/4-1/8	1/4	6.35	1/8	4.57	4.57	7/16	11.11	15.75	31.80
30-MA-1/4-1/4	1/4	6.35	1/4	6.35	4.57	9/16	14.28	15.75	37.08
30-MA-1/4-3/8	1/4	6.35	3/8	7.93	4.57	11/16	17.46	15.75	37.84
30-MA-1/4-1/2	1/4	6.35	1/2	11.90	4.57	7/8	22.22	15.75	43.43
30-MA-5/16-1/8	5/16	7.93	1/8	2.28	6.35	7/16	11.11	16.80	32.76
30-MA-5/16-1/4	5/16	7.93	1/4	6.35	6.35	9/16	14.28	16.80	38.10
30-MA-3/8-1/8	3/8	9.52	1/8	4.82	7.11	7/16	11.11	17.50	33.50
30-MA-3/8-1/4	3/8	9.52	1/4	7.11	7.11	9/16	14.28	17.50	38.90
30-MA-3/8-3/8	3/8	9.52	3/8	7.93	7.11	11/16	17.46	17.50	39.60
30-MA-3/8-1/2	3/8	9.52	1/2	11.90	7.11	7/8	22.22	17.50	45.20
30-MA-1/2-1/4	1/2	12.70	1/4	6.35	9.90	9/16	14.28	23.20	44.50
30-MA-1/2-3/8	1/2	12.70	3/8	7.93	9.90	11/16	17.46	23.20	45.20

All dimensions are in millimeters unless otherwise specified, for reference only and subject to change.

## Tube Stub Adapter eliminates alignment problems.

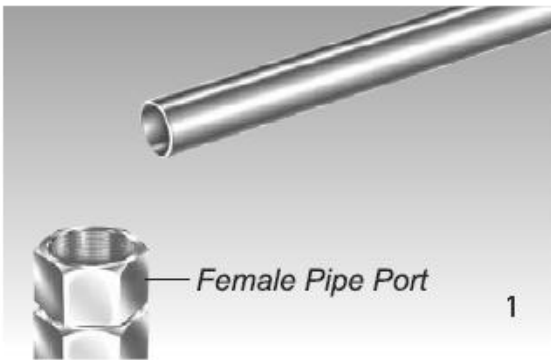

In the direction shown the female port is required to connect with tubing.

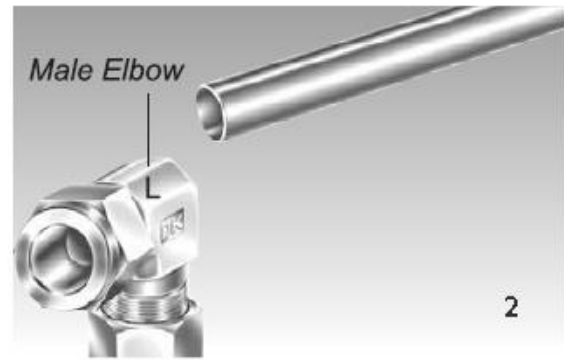

The male elbow is positioning in the wrong direction.

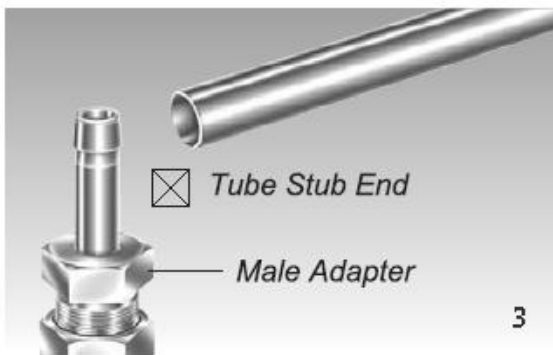

To eliminate the problem, use a male adapter into the female port.

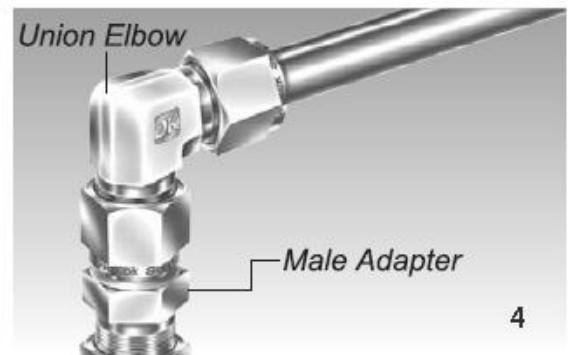

Installation instruction.

1. Insert the tube stub end into the DK-Lok port
  - Make sure that the tube stub end bottoms on the fitting body shoulder.
2. Spanner-tighten the nut 1 1/4 turns beyond the **finger tight position**.
  - Tighten the nut 3/4 turn for 1/8, and 3/16 in.; 3, and 4 mm Tube Fittings.

Note: For re-use, see re-assembly instruction.



### Operating Pressures & Temperatures - Stainless Steel Compression Tubing

- Applications Include: Compression, Instrumentation, Vacuum, Gas, Cryogenic, High pressure & Temperature Service.
- These tube fittings are designed using industrial codes and specifications with additional cutting-edge engineering on swaging action and sealing integrity.
- They also provide excellent leak-free sealing on high pressure gas, vacuum, impulse, thermal shock, heavy vibration and many other stringent applications.
- All tube fittings are double ferrule and consist of a body, front ferrule, back ferrule and nut.
- Stainless steel bar stock conforms to ASTM A276, ASTM 479, ASME SA479 and JIS GA 303
- Stainless steel forged fittings conform to ASTM A182, ASME SA 182 and JIS G3214
- The pressure rating of a BFO Tube Fitting is rated to the [working pressure of the connective tubing](#).