

FEMALE ELBOW

4001 – FEMALE x FEMALE NPT

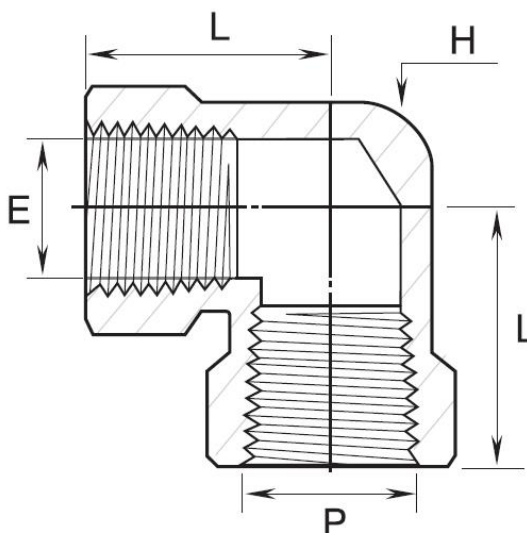

End Connection: Female NPT to Female NPT Threads

Series: Standard High Pressure Instrumentation Threaded Fittings

Part Number	P NPT in.	L mm	E mm	H Wrench Flat (mm)	Pressure Rating psi (bar)	
					SS316, C.Steel	Brass
4001-M	1/8	24.1	8.9	12.7	6200 (427)	3100 (213)
4001-N	1/4	29.0	11.7	17.5	7200 (496)	3600 (248)
4001-O	3/8	34.5	15.0	20.6	5600 (385)	2800 (192)
4001-P	1/2	37.0	18.7	25.4	5600 (385)	2800 (192)
4001-Q	3/4	46.5	23.5	31.8	5100 (351)	2500 (172)
4001-R	1	48.8	29.7	42.9	6400 (440)	3200 (220)

**All dimensions are in millimeters unless otherwise specified, for reference only and subject to change.



Instrumentation Pipe & Weld Fittings Specifications & Pressure Ratings

- Wrench flat body design allowing standard hex wrench assembly
- Attractive finishes to suit precision equipment.
- Much less-weight design compared to Class 3000 pipe fittings.
- Fine pipe thread construction equals or exceeds the requirement of ASME B1.20.1 to ensure maximum thread engagement.
- Male pipe threads capped for protection from damages.
- Fitting materials available in SS316, Brass and Carbon Steel.
- These Standard Rating Fittings are designed to the requirements of ASME B31.3 process piping code.
- These pipe thread sizes are available 1/8 in. to 1 in. NPT