

HEX COUPLING

4031 – FEMALE NPT x FEMALE NPT

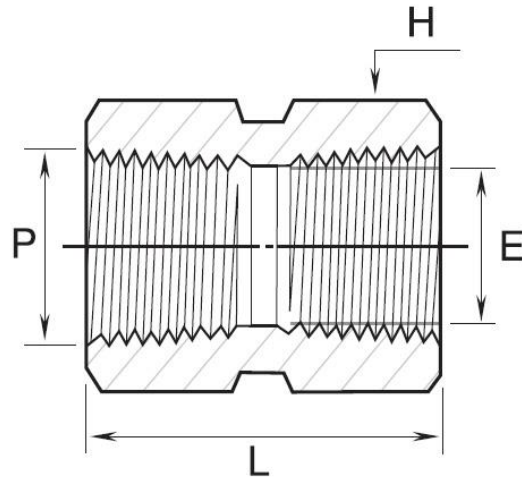

End Connection: Female NPT to Equal Female NPT Threads
Series: Standard High Pressure Instrumentation Threaded Fittings

Part Number	(P) NPT in.	(L) mm	(E) mm	(H) Hex mm
4031-M	1/8	20.57	8.9	14.2
4031-N	1/4	30.22	10.87	19.05
4031-O	3/8	33.27	15.0	22.2
4031-P	1/2	39.62	18.7	26.9
4031-Q	3/4	41.14	23.5	33.3
4031-R	1	50.8	29.7	41.2

**All dimensions are in millimeters unless otherwise specified, for reference only and subject to change.
**BFO is able to provide a quote for all items listed in this table.

REDUCING HEX COUPLING

4031 – FEMALE NPT x REDUCED FEMALE NPT

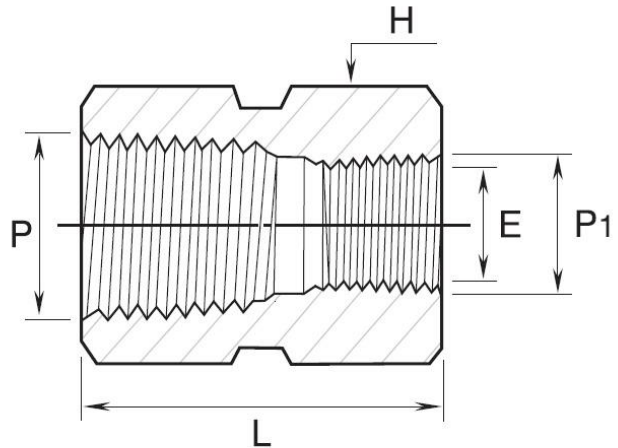

End Connection: Female NPT to Reduced Female NPT Threads
Series: Standard High Pressure Instrumentation Threaded Fittings

Part Number	(P) NPT in.	(P1) Reduced NPT in.	(L) mm	(E) mm	(H) Hex mm
4031-NM	1/4	1/8	31.2	8.9	19.05
4031-ON	3/8	1/4	34.8	11.7	22.2
4031-PM	1/2	1/8	39.4	8.7	26.9
4031-PN	1/2	1/4	44.2	11.7	26.9
4031-PO	1/2	3/8	45.0	15.0	26.9
4031-QN	3/4	1/4	45.7	11.7	33.3
4031-RQ	1	3/4	57.0	23.5	41.2

**All dimensions are in millimeters unless otherwise specified, for reference only and subject to change.

**BFO is able to provide a quote for all items listed in this table.



PDF Spec Sheet Includes the following:

- **Threaded Fittings Standard Pressure Ratings**
 - **Material Standards and Temperature Ratings**
 - **Temperature De-Rating Factors**
 - **Temperature Ratings of O-Ring, Gasket Materials**
 - **Pipe Thread Designators**
-

Features of Threaded Fittings:

- Wrench flat body design allowing standard hex wrench assembly
- Attractive finishes to suit precision equipment.
- Much less-weight design compared to Class 3000 pipe fittings.
- Fine pipe thread construction equals or exceeds the requirement of ASME B1.20.1 to ensure maximum thread engagement.
- Male pipe threads capped for protection from damages.
- Fitting materials available in SS316, Brass and Carbon Steel.
- These Standard Rating Fittings are designed to the requirements of ASME B31.3 process piping code.
- These pipe thread sizes are available 1/8 in. to 1 in. NPT