

MALE TEE

4055 – MALE x MALE x MALE NPT

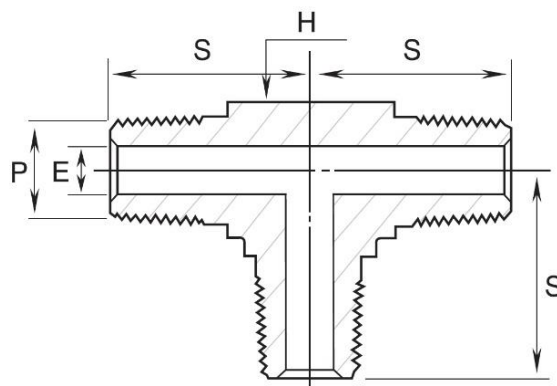

End Connection: Male NPT x Male NPT x Male NPT

Series: Standard High Pressure Instrumentation Threaded Fittings

Part Number	P NPT in.	S mm	E mm	H Wrench Flat mm	Pressure Rating psig (bar)	
					SS316, C.Steel	Brass
4055-M	1/8	19.05	4.8	12.7	10000 (689)	5000 (344)
4055-N	1/4	24.5	7.1	12.7	8000 (551)	4000 (275)
4055-O	3/8	26.9	9.6	17.5	7800 (537)	3900 (268)
4055-P	1/2	33.2	11.9	20.6	7700 (530)	3800 (261)
4055-Q	3/4	35.3	15.7	25.4	7300 (502)	3600 (248)
4055-R	1	44.5	22.3	31.8	5300 (365)	2600 (179)

**All dimensions are in millimeters unless otherwise specified, for reference only and subject to change.



Instrumentation Pipe & Weld Fittings

Specifications & Pressure Ratings

- Wrench flat body design allowing standard hex wrench assembly
- Attractive finishes to suit precision equipment.
- Much less-weight design compared to Class 3000 pipe fittings.
- Fine pipe thread construction equals or exceeds the requirement of ASME B1.20.1 to ensure maximum thread engagement.
- Male pipe threads capped for protection from damages.
- Fitting materials available in SS316, Brass and Carbon Steel.
- These Standard Rating Fittings are designed to the requirements of ASME B31.3 process piping code.
- These pipe thread sizes are available 1/8 in. to 1 in. NPT