

STRAIGHT ADAPTERS

4051 – MALE NPT x EQUAL FEMALE NPT

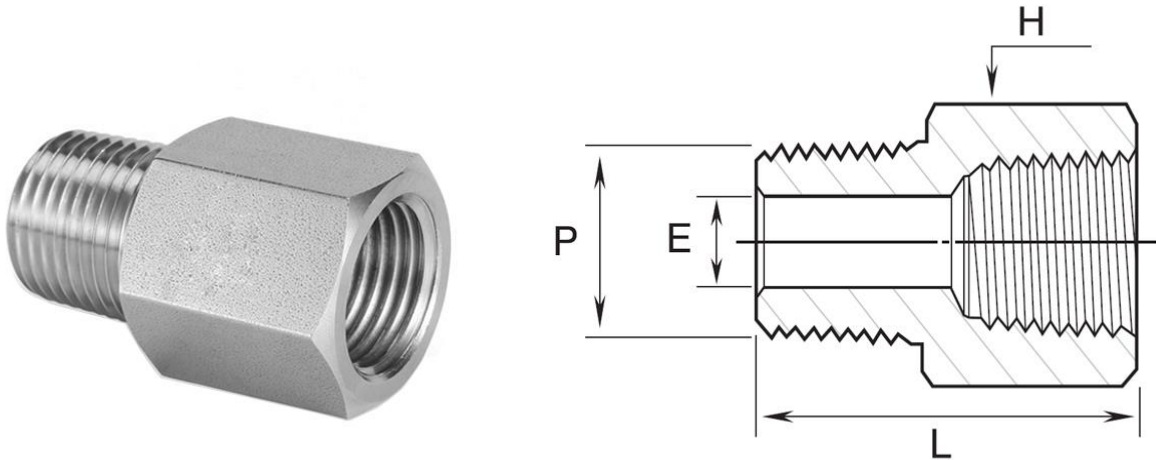

End Connection: Male NPT to Equal Female NPT Threads
Series: Standard High Pressure Instrumentation Threaded Fittings

Part Number	P Male NPT (in.)	L mm	E mm	H Hex (mm)
4051-M	1/8	27.94	4.8	14.2
4051-N	1/4	35.56	7.1	19.05
4051-O	3/8	38.35	9.6	22.2
4051-P	1/2	49.27	11.9	26.9
4051-Q	3/4	51.3	15.7	33.3
4051-R	1	57.91	22.3	41.2

**All dimensions are in millimeters unless otherwise specified, for reference only and subject to change.

REDUCING ADAPTERS

4051 – MALE NPT x LARGER FEMALE NPT

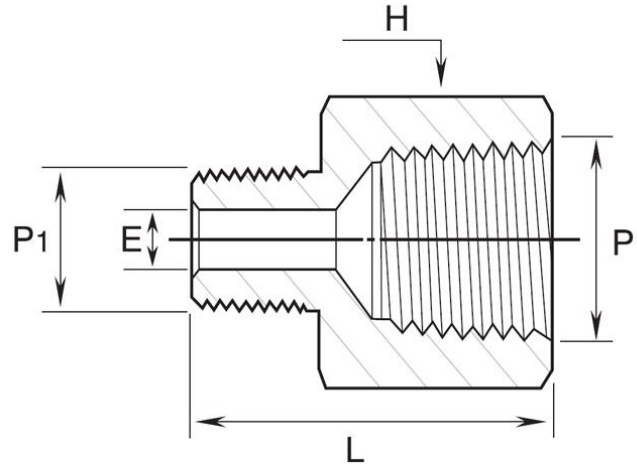

End Connection: Male NPT to **Larger** Female NPT Threads
Series: Standard High Pressure Instrumentation Threaded Fittings

Part Number	P1 Male NPT in.	P Female NPT in.	L mm	E mm	H Hex mm
4051-NM	1/8	1/4	31.5	4.8	19.05
4051-OM	1/8	3/8	33.5	4.8	22.2
4051-ON	1/4	3/8	37.8	7.1	22.2
4051-PM	1/8	1/2	40.0	4.8	26.9
4051-PN	1/4	1/2	44.5	7.1	26.9
4051-PO	3/8	1/2	44.5	9.6	26.9
4051-QN	1/4	3/4	45.7	7.1	33.3
4051-QO	3/8	3/4	45.7	9.6	33.3
4051-QP	1/2	3/4	51.1	11.9	33.3
4051-RO	1/4	1	50.8	7.1	41.2
4051-RP	1/2	1	54.9	11.9	41.2
4051-RQ	3/4	1	55.1	15.7	41.2

**All dimensions are in millimeters unless otherwise specified, for reference only and subject to change.



Instrumentation Pipe & Weld Fittings Specifications & Pressure Ratings

PDF Spec Sheet Includes the following:

- **Threaded Fittings Standard Pressure Ratings**
 - **Material Standards and Temperature Ratings**
 - **Temperature De-Rating Factors**
 - **Temperature Ratings of O-Ring, Gasket Materials**
 - **Pipe Thread Designators**
-

Features of Threaded Fittings:

- Wrench flat body design allowing standard hex wrench assembly
- Attractive finishes to suit precision equipment.
- Much less-weight design compared to Class 3000 pipe fittings.
- Fine pipe thread construction equals or exceeds the requirement of ASME B1.20.1 to ensure maximum thread engagement.
- Male pipe threads capped for protection from damages.
- Fitting materials available in SS316, Brass and Carbon Steel.
- These Standard Rating Fittings are designed to the requirements of ASME B31.3 process piping code.
- These pipe thread sizes are available 1/8 in. to 1 in. NPT