

Y-Ball Check Valve (45BY) 

Y-Ball Check Valves are used to prevent back flow. When liquid flows through the valve during processing, the ball is forced into the branch allowing full flow. When the liquid stops, the ball returns to the seat, preventing back flow.

FEATURES:

- All metal product contact surfaces are 316L stainless steel
- Polished 32Ra finish on all wetted surfaces
- PTFE ball
- Two-piece construction
- Field serviceable (no special tools required)
- Air blow check valve can be added
- Operating Temperature Range: 15°F to 200°F
- Maximum Operating Pressure: 150 PSI
- Repair kits available for seal kits and PTFE ball
- Available with either EPDM or FKM seat material
- 3A certified (58-02) #3773



SPECIFICATIONS:

VALVE	WEIGHT (lbs)	CAP SIZE	CLAMP SIZE	CAP GASKET	BALL DIAMETER	CRACKING PRESSURE INCHES (H2O)		SEATING PRESSURE (PSI)		FLOW COEFFICIENT (Cv)
						VERTICAL	HORIZONTAL	VERTICAL	HORIZONTAL	
1-1/2"	4.9	2.0	2.0	2.0	1.6	2.0	0.5	3.6	3.9	60
2"	6.6	2.5	2.5	2.5	2.1	2.5	0.5	2.6	3.7	80
2-1/2"	10.5	3.0	3.0	3.0	2.7	3.0	0.5	1.6	2.4	100
3"	17.5	4.0	4.0	4.0	3.6	3.8	0.5	1.9	2.6	140

Y-BALL CHECK VALVES 45BY 

VALVE SIZE	EPDM	FKM
1-1/2"	W645BY-E-15	W645BY-V-15
2"	W645BY-E-2	W645BY-V-2
2-1/2"	W645BY-E-25	W645BY-V-25
3"	W645BY-E-3	W645BY-V-3

REPLACEMENT PARTS

VALVE SIZE	SEAL KITS EPDM	SEAL KITS FKM	REPLACEMENT BALL - PTFE
1-1/2"	W45BY-ST-E-15	W45BY-ST-V-15	W45BY-B-15
2"	W45BY-ST-E-2	W45BY-ST-V-16	W45BY-B-2
2-1/2"	W45BY-ST-E-25	W45BY-ST-V-17	W45BY-B-25
3"	W45BY-ST-E-3	W45BY-ST-V-18	W45BY-B-3

• Seal kit includes (1) EPDM/FKM cap gasket and (1) EPDM/FKM/CF8M Seat

SIZING CHART

When using air blow check valves with ball check valves, refer to this sizing chart.

BALL CHECK VALVE SIZE	AIR BLOW CHECK VALVE SIZE
1-1/2"	2"
2"	2-1/2"
2-1/2"	3"
3"	4"

Y-Ball Check Valve (45BY)

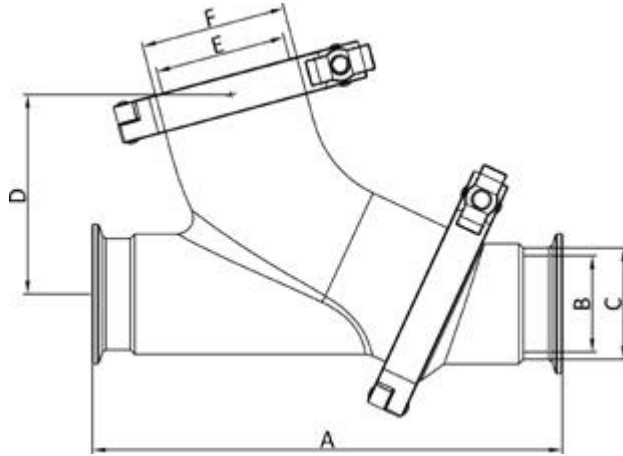

DIMENSIONS (INCHES)

SIZE	A	B	C	D	E	F
1-1/2"	7.5	1.37	1.5	3.3	1.9	2.5
2"	8.5	1.87	2.0	3.9	2.3	3.0
2-1/2"	10	2.37	2.5	4.5	2.9	3.6
3"	11.5	2.87	3.0	5.3	3.8	4.7

EXPLODED VIEW



ITEM	DESCRIPTION	MATERIAL	QTY
1	Angle Body	316L	1
2	Inlet Body	316L	1
3	Single Pin Clamp	CF8	2
4	End Cap	316L	1
5	Cap Gasket	EPDM / FKM	1
6	Ball	PTFE	1
7	Seat	EPDM or FKM / 316L	1