

Technical Specifications:

- Forged stainless steel material conforms to ASME A182
- Forged stainless steel flange dimensions conform to ASME B16.5
- NPT threads conform to ASME B1.20.1
- Manufacturing facility is ISO 9001:2008

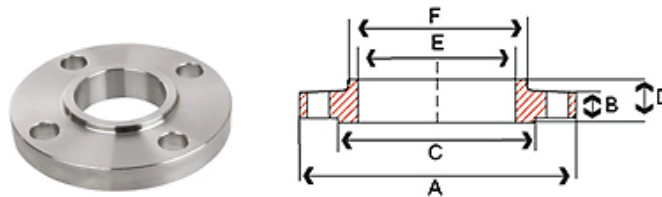

150# Stainless Steel Socket Weld Flanges – 304/304L & 316/316L – Raised Face 1/16"
Schedule 40

Size IN	A IN	B IN	C IN	D IN	E IN	F IN	G IN	H IN	Bolt Circle IN	Bolt Hole Diameter IN	# of Bolt Holes	Weight lbs
1/2	3.50	0.44	1.38	0.88	0.62	0.38	1.19	0.62	2.38	0.62	4	1
3/4	3.88	0.50	1.69	1.09	0.62	0.44	1.50	0.82	2.75	0.62	4	2
1	4.25	0.56	2.00	1.36	0.69	0.50	1.94	1.05	3.12	0.62	4	2
1-1/4	4.62	0.62	2.50	1.70	0.81	0.56	2.31	1.38	3.50	0.62	4	3
1-1/2	5.00	0.69	2.88	1.95	0.88	0.62	2.56	1.61	3.88	0.62	4	3
2	6.00	0.75	3.62	2.44	1.00	0.69	3.06	2.07	4.75	0.75	4	5
2-1/2	7.00	0.88	4.12	2.94	1.12	0.75	3.56	2.47	5.50	0.75	4	7
3	7.50	0.94	5.00	3.57	1.19	0.81	4.25	3.07	6.00	0.75	4	8
4	9.00	0.94	6.19	4.60	1.31	0.94	5.31	4.03	7.50	0.75	8	13
5	10.00	0.94	7.31	5.66	1.44	0.94	6.44	5.05	8.50	0.88	8	15
6	11.00	1.00	8.50	6.72	1.56	1.06	7.56	6.07	9.50	0.88	8	19

150# Stainless Steel Socket Weld Flanges – 304/304L & 316/316L – Raised Face 1/16"
Schedule 80

Size IN	A IN	B IN	C IN	D IN	E IN	F IN	G IN	H IN	Bolt Circle IN	Bolt Hole Diameter IN	# of Bolt Holes	Weight lbs
1/2	3.50	0.44	1.38	0.88	0.62	0.38	1.19	0.62	2.38	0.62	4	1
3/4	3.88	0.50	1.69	1.09	0.62	0.44	1.50	0.82	2.75	0.62	4	2
1	4.25	0.56	2.00	1.36	0.69	0.50	1.94	1.05	3.12	0.62	4	2
1-1/4	4.62	0.62	2.50	1.70	0.81	0.56	2.31	1.38	3.50	0.62	4	3
1-1/2	5.00	0.69	2.88	1.95	0.88	0.62	2.56	1.61	3.88	0.62	4	3
2	6.00	0.75	3.62	2.44	1.00	0.69	3.06	2.07	4.75	0.75	4	5
2-1/2	7.00	0.88	4.12	2.94	1.12	0.75	3.56	2.47	5.50	0.75	4	7
3	7.50	0.94	5.00	3.57	1.19	0.81	4.25	3.07	6.00	0.75	4	8
4	9.00	0.94	6.19	4.60	1.31	0.94	5.31	4.03	7.50	0.75	8	13

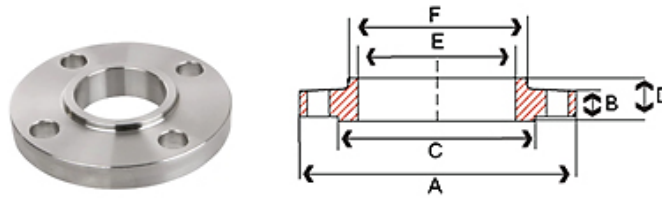

300# Stainless Steel Socket Weld Flanges – 304/304L & 316/316L – Raised Face 1/16"
Schedule 40

Size IN	A IN	B IN	C IN	D IN	E IN	F IN	G IN	H IN	Bolt Circle IN	Bolt Hole Diameter IN	# of Bolt Holes	Weight lbs
1/2	3.75	0.56	1.38	0.88	0.88	0.38	1.50	0.62	2.62	0.62	4	2
3/4	4.62	0.62	1.69	1.09	1.00	0.44	1.88	0.82	3.25	0.75	4	3
1	4.88	0.69	2.00	1.36	1.06	0.50	2.12	1.05	3.50	0.75	4	3
1-1/4	5.25	0.75	2.50	1.70	1.06	0.56	2.50	1.38	3.88	0.75	4	4
1-1/2	6.12	0.81	2.88	1.95	1.19	0.62	2.75	1.61	4.50	0.88	4	6
2	6.50	0.88	3.62	2.44	1.31	0.69	3.31	2.07	5.00	0.75	8	7
2-1/2	7.50	1.00	4.12	2.94	1.50	0.75	3.94	2.94	5.88	0.88	8	10
3	8.25	1.12	5.00	3.57	1.69	0.81	4.62	3.57	6.62	0.88	8	13
4	10.00	1.25	6.19	4.60	1.88	-	5.75	4.03	7.88	0.88	8	22

300# Stainless Steel Socket Weld Flanges – 304/304L & 316/316L – Raised Face 1/16"
Schedule 80

Size IN	A IN	B IN	C IN	D IN	E IN	F IN	G IN	H IN	Bolt Circle IN	Bolt Hole Diameter IN	# of Bolt Holes	Weight lbs
1/2	3.75	0.56	1.38	0.88	0.88	0.38	1.50	0.62	2.62	0.62	4	2
3/4	4.62	0.62	1.69	1.09	1.00	0.44	1.88	0.82	3.25	0.75	4	3
1	4.88	0.69	2.00	1.36	1.06	0.50	2.12	1.05	3.50	0.75	4	3
1-1/4	5.25	0.75	2.50	1.70	1.06	0.56	2.50	1.38	3.88	0.75	4	4
1-1/2	6.12	0.81	2.88	1.95	1.19	0.62	2.75	1.61	4.50	0.88	4	6
2	6.50	0.88	3.62	2.44	1.31	0.69	3.31	2.07	5.00	0.75	8	7
2-1/2	7.50	1.00	4.12	2.94	1.50	0.75	3.94	2.94	5.88	0.88	8	10
3	8.25	1.12	5.00	3.57	1.69	0.81	4.62	3.57	6.62	0.88	8	13
4	10.00	1.25	6.19	4.60	1.88	-	5.75	4.03	7.88	0.88	8	22