

## PORT CONNECTOR PC

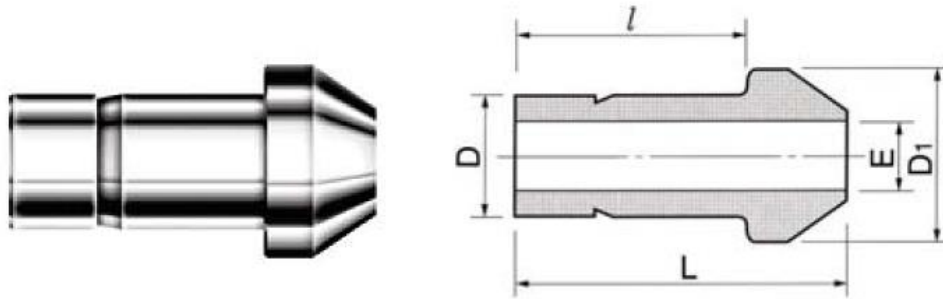

Connects two fractional BFO-Lok ports  
Classification: Tube Stub Connector

Part No.	Tube O.D. (D)		E Min	D1	l	L
	in.	mm				
30-PC-1/16	1/16	1.59	1.00	3.30	10.66	13.72
30-PC-1/8	1/8	3.17	1.77	6.09	15.75	22.35
30-PC-1/4	1/4	6.35	4.57	9.39	18.79	24.64
30-PC-5/16	5/16	7.93	6.35	10.92	20.06	25.90
30-PC-3/8	3/8	9.52	7.11	12.70	20.32	26.16
30-PC-1/2	1/2	12.70	9.90	15.74	25.90	35.81
30-PC-3/4	3/4	19.05	14.98	22.09	27.68	37.33
30-PC-1	1	25.40	20.06	28.44	34.54	48.00

All dimensions are in millimeters unless otherwise specified and only for reference and subject to change.  
Request a quote for any sizes not listed online.

# INSTALLATION INSTRUCTIONS

## Machined Ferrule End and Tube Stub End

Port Connector is useful for close connection of two BFO-Lok ports.

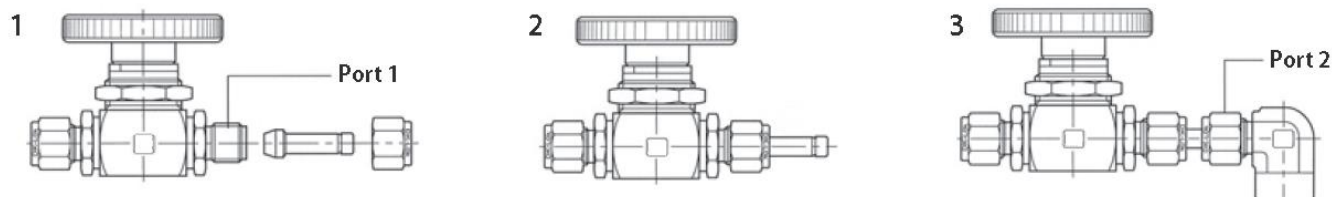

Be aware that Port Connector consists of machined ferrule end, and tube stub end. These two ends require different installation.

### Machined Ferrule End Refers to Fig. 1 & 2.

1. Remove the nut and ferrules from BFO-Lok port 1.
  2. Place the nut over the machined ferrule end of the port connector.
  3. Finger-tighten the nut onto the port 1.
  4. Wrench-tighten the nut 1/4 turn, keeping the body steady with a backup wrench.
- Do not tighten 1-1/4 turns. This is not the standard ferrule.
  - Tightens 1/8 turn for 1/16, and 1/8 in.; 3, and 4mm Tube Fittings.

### Tube Stub End Refers to Fig. 3.

1. Insert the tube stub end into the port 2 until it is bottomed on the shoulder of the body.
  2. Finger-tighten the nut on port 2.
  3. Wrench-tighten the nut 1 1/4 turns, keeping the port 2 body steady with a backup wrench.
- Tighten the nut 3/4 turn for 1/16, and 1/8 in.; and 3, and 4mm Tube Fittings.
  - For re-use, see re-assembly instruction.

## ADDITIONAL PRODUCT INFORMATION

Tube stub connectors are designed to eliminate difficult alignment issues, reduce from or increase to one tube system size to another, convert between fractional and metric tube connections, or create non-standard configurations by assembling with standard stock items in both single ferrule and double ferrule designs.



## PORT CONNECTORS

- Uses include: instrumentation, high pressure and temperature, cryogenic service, and process and control systems where high-quality tube fittings are required.
- These tube fittings are designed using industrial codes and specifications with additional cutting-edge engineering on swaging action and sealing integrity.
- They also provide excellent leak-free sealing on high pressure gas, vacuum, impulse, thermal shock, heavy vibration and many other stringent applications.
- All tube fittings are double ferrule and consist of a body, front ferrule, back ferrule and nut.
- Stainless steel bar stock conforms to ASTM A276, ASTM 479, ASME SA479 and JIS GA 303
- Stainless steel forged fittings conform to ASTM A182, ASME SA 182 and JIS G3214
- The pressure rating of a BFO Tube Fitting is rated to the [working pressure of the connective tubing](#).
- CAD drawings available upon request.

COMPETITOR PART NUMBER CROSSOVER			
ITEM #	SWAGELOK	SSP DUOLOK	PARKER A-LOK
30-PC-1/8	SS-201-CP	ISSD2CP	2CP2-SS
30-PC-1/4	SS-401-CP	ISSD4CP	4CP4-SS
30-PC-5/16	SS-501-CP	ISSD5CP	5CP5-SS
30-PC-3/8	SS-601-CP	ISSD6CP	6CP6-SS
30-PC-1/2	SS-811-CP	ISSD8CP	8CP8-SS
30-PC-3/4	SS-1211-CP	ISSD12CP	12CP12-SS
30-PC-1	SS-1611-CP	ISSD16CP	16CP16-SS